



GRAPHIC SCALE
0 50



1" = 50'

Intersection of
Lake Street &
Washington Street

Marquette Yacht Club
Property Boundary
and
Existing and Proposed
Conveyances



City of Marquette
300 West Baraga Avenue
Marquette, MI 49855

09-15-2023

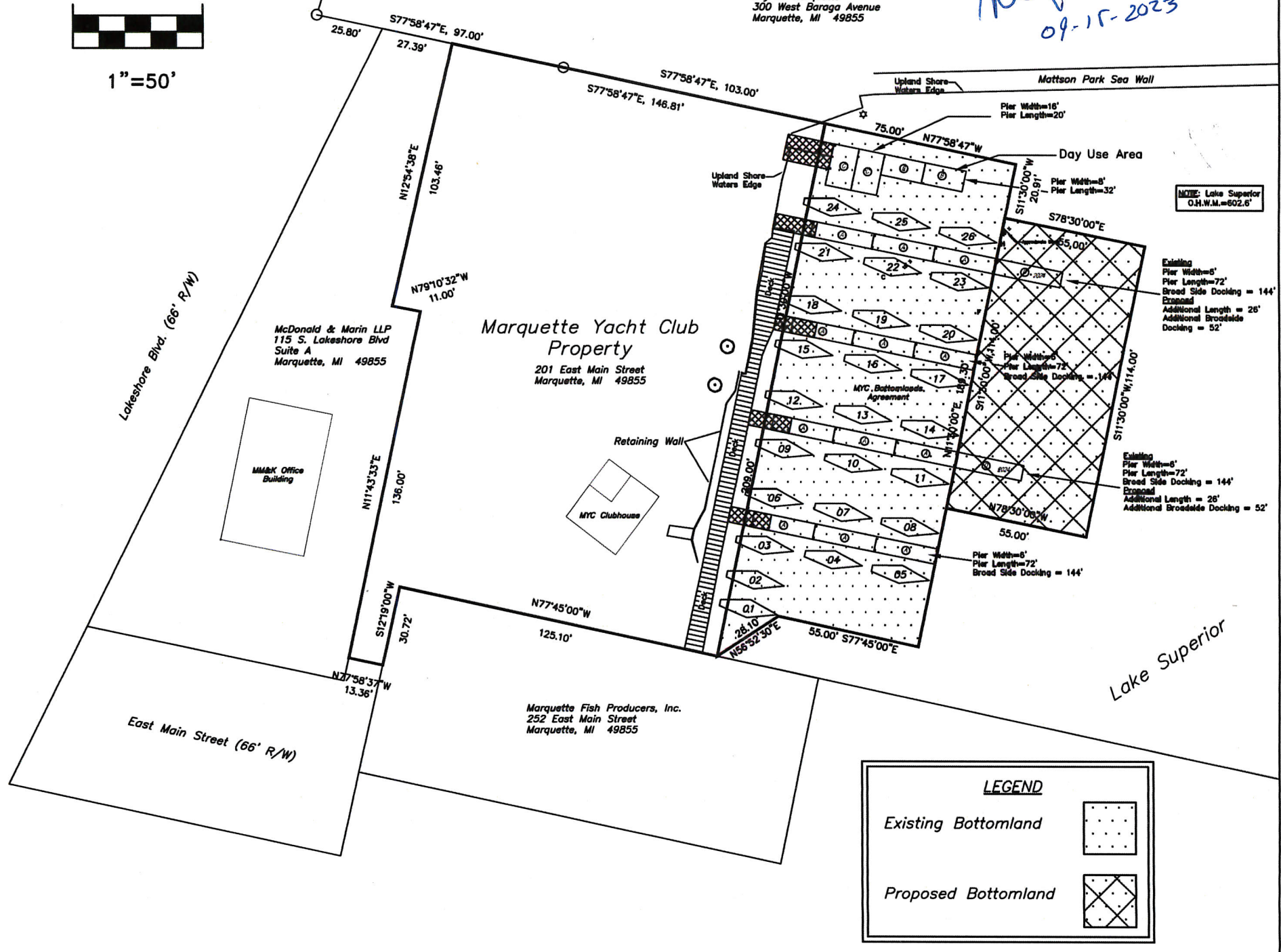

LEGEND

Existing Bottomland

Proposed Bottomland

TYPICAL
HIGH FLOAT DOCK
CUBE STYLE FLOTATION
w/ PIPE ANCHORS

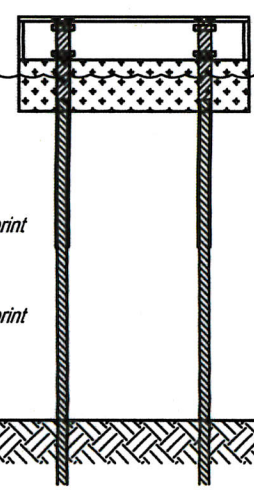

A
24'x6'
Dock Footprint
D
26'x6'
Dock Footprint

TYPICAL
LOW FLOAT FINGER
CUBE STYLE FLOTATION
w/ PIPE ANCHORS

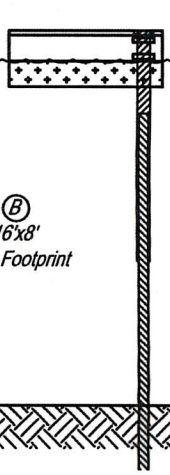

B
16'x8'
Dock Footprint

TYPICAL
LOW FLOAT DECK
CUBE STYLE FLOTATION
w/ PIPE ANCHORS

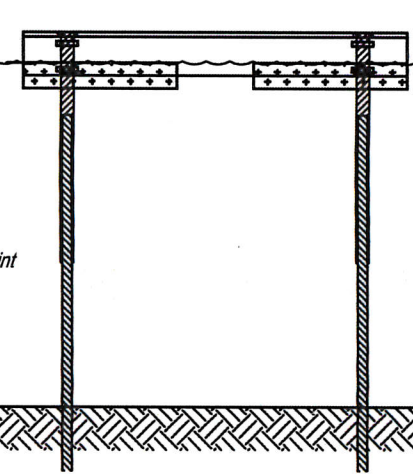

C
16'x10'
Dock Footprint

- Existing Bottomland
- Proposed Bottomland
- Anchor Pipe
- Pipe Section
- Lake Bottom
- Flotation
- Ramp
- Deck

LEGEND

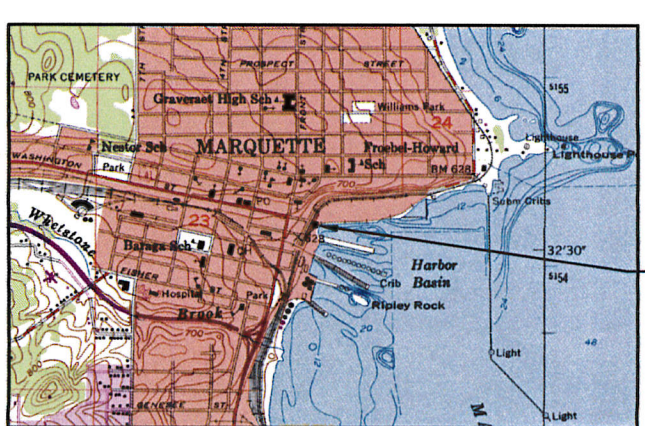

VICINITY SKETCH

MYC SITE PLAN

APPLICANT: MARQUETTE YACHT CLUB
 WATERWAY: LAKE SUPERIOR
 CITY: MARQUETTE
 TOWNSHIP: N/A
 COUNTY: MARQUETTE
 SHEET: 1 of 2
 DATE: 09/14/2023

FINAL