

**AGREEMENT FOR USE OF LAKEVIEW ARENA**

This Agreement, made and entered into this \_\_\_\_ day of \_\_\_\_\_ 2021, by and between the **CITY OF MARQUETTE**, a Michigan municipal corporation, of 300 W. Baraga Avenue, Marquette, MI 49885 (hereinafter referred to as the “City”) and **MARQUETTE AREA PUBLIC SCHOOLS (VARSITY HOCKEY)**, of 1201 W. Fair Avenue, Marquette, MI 49885 (hereinafter referred to as the “User Group”).

WHEREAS, the City is the owner and operator of Lakeview Arena at 401 E. Fair Avenue, Marquette, Michigan; and

WHEREAS, the City is willing to lease to User Group space as shown in Exhibit “A” in Lakeview Arena in accordance with the terms and conditions contained herein from November 1, 2021, through March 31, 2022.

NOW, THEREFORE, in consideration of the mutual promises of the parties and other good and valuable consideration, it is agreed as follows:

1. In consideration variable monthly payments of \$5,787.50, as adjusted monthly to reflect all additional hours or fewer hours of use, the User Group shall be entitled to exclusive use of the Lakeview Arena ice sheet specified in Exhibit “A” for the times listed under "Customer Schedule" which includes 118.00 hours. The City will invoice the User Group monthly and payment shall be due with 30 days of the date of the invoice.

2. Should the User Group wish to lease its ice time to another responsible group, at the same rate, during the contract period, it may do so upon forty-eight (48) hours minimum notice to the City. Such sub-lease of User Group ice time shall be made and transacted between the parties and not involve the City. The City retains the right to deny such use for cause which shall not be unreasonably withheld.

3. Food and beverage service operated by the City, or by those persons contracting

with the City to provide said services, will be available to others during advertised special events. The City will work with the User Group to coordinate food service.

4. Arena facilities to hold board meetings, work sessions, planning sessions, award presentations, judiciary hearings, and other limited approved events will be made at no additional cost to the User Group, in locations determined by the Arena Management and subject to availability.

5. The User Group recognizes that use of Arena facilities must be properly planned. User Group will provide a minimum of forty-eight (48) hours notice to the City in the event of any facility use changes, including cancellation, change of time, or additional use, and will maintain the facilities as they were found prior to their use.

6. The User Group understands and agrees that there is inherent danger and risk of injury to those individuals participating in an observing the User's Group's activities. The User Group expressly agrees to assume the full risk of and responsibility for any and all injuries, accidents, or damages (including death) that may occur as a result of participating in or observing the User's Group's activities except to the extent caused by the City's gross negligence or intentional misconduct, and the User Group releases the City, its officers, directors, agents, representatives, contractors and employees from such liability.

7. The User Group agrees to release, indemnify and hold harmless the City, its officers, directors, agents, representatives, contractors and employees from any and all claims, including attorney fees and costs, that may be brought against it by anyone claiming to have been injured or damaged as a result of the User Group's use of or activities, including but not limited to bodily injury, property damage or other injury or damage that may occur in connection with User Group's activities, except to the extent caused by the City's gross negligence or intentional misconduct.

8. The User Group shall procure and maintain insurance for the duration of this

Agreement against liability claims for injuries to persons or damages to property which may arise from or in connection with the use of Lakeview Arena and naming the City as an additional insured. The insurance required by this Agreement shall be in amounts acceptable to the City and shall be endorsed to state that coverage shall not be reduced or canceled except after thirty (30) days notice to the City by certified mail, return receipt requested.

9. The occurrence of any of the following shall constitute a default by the User Group:
  - a. Abandonment and vacation of Lakeview Arena during the Agreement.
  - b. Failure to perform any provision of this Agreement, if the failure to perform is not cured within thirty (30) days after the City provides written notice to the User Group.
  - c. Failure to maintain insurance as required by this Agreement, which shall be cause for immediate termination of this Agreement by the City.
  - d. Failure to comply with any law or government order.
  - e. The User Group files a petition in bankruptcy or insolvency or for reorganization, or involuntary proceedings are filed against the User Group under applicable bankruptcy laws.
  - f. The User Group fails to make any payment when due.

10. In the event of default, the City shall provide the User Group written notice of default. The User Group shall have thirty (30) days after notice is provided to cure said default. No notice shall be deemed a forfeiture or termination of this Agreement unless the City specifies such in the notice. In the event the User Group does not cure the default within the allowed thirty (30) day time period, the City shall have the following remedies, which shall not be exclusive and shall be in addition to any other remedies now or later allowed by law:

- a. The City may elect to continue this Agreement.
- b. The City may terminate the User Group's right to possession of Lakeview

Arena at any time, by providing specific written notice to this effect.

c. The City shall be entitled to recover all amounts, including any attorney fees incurred by the City in pursuit of the default.

11. Any notice required under this Agreement shall be in writing and served by prepaid, first class mail to the address listed on the first page of this Agreement, or any other address as either party may provide to the other in writing.

12. No delay or omission in the exercise of any right or remedy of the City on any default by the User Group shall impair such right or remedy or be construed as a waiver of the right to pursue such remedy.

13. Nothing in this lease shall render the City in any way a partner, in joint ventureship with the User Group.

14. Upon the expiration or termination of this Agreement, the User Group shall at its sole expense:

a. Remove all of its goods, effects, and equipment.

b. Surrender the premises to the City.

Any goods, effects or equipment owned by the User Group that is not removed shall be deemed to have been abandoned and shall become the property of the City.

15. By executing this Agreement and taking possession pursuant to the terms contained herein, the User Group acknowledges that Lakeview Arena is in the condition called for by this Agreement.

16. This Agreement contains the entire agreement of the parties with respect to its subject matter. This Agreement may not be modified except by a written document signed by the parties.

17. This Agreement shall bind and benefit the parties and their successors and permitted assigns.

18. This contract is executed in the City of Marquette, State of Michigan, and shall be construed under the laws of the State of Michigan, and the parties agree that any action relating to this contract shall be instituted and prosecuted in the courts of the County of Marquette, State of Michigan, and each party waives the right to change of venue.

19. In the event the Arena is required to temporarily close pursuant to any law or government order, User Group will be prohibited from entering the Arena. In such event, User Group will be billed, and agrees to pay, for actual usage during such time.

CITY OF MARQUETTE

MARQUETTE AREA PUBLIC SCHOOLS

\_\_\_\_\_  
Jennifer A. Smith, Mayor

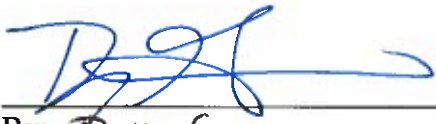
  
\_\_\_\_\_  
By: Doug Garraw  
Its: MSHS, Varsity Hockey Coach

\_\_\_\_\_  
Kyle Whitney, City Clerk

APPROVED AS TO SUBSTANCE:

\_\_\_\_\_  
Karen M. Kovacs, City Manager

APPROVED AS TO FORM:

\_\_\_\_\_  
Suzanne C. Larsen, City Attorney



# Lakeview Arena

300 W. Baraga Ave.  
Marquette, MI 49855

Phone: 906-228-0460

Fax: 906-228-0493

## Account Schedule Report

Phone: 906-225-5362

Email: atiseo@mapsnet.org

**MSHS Varsity Hockey Marquette Area Public Schools**  
Alex Tiseo  
1203 W Fair Ave

### Account Schedule - By Date 9/27/2021 - 3/31/2022

Date	Day	Complex	Facility	Event Type	Event Time	Cleanup	Dur.	Rate	Other Chg	Tax	Total
11/1/2021	Mon	LA	Russell Arena	Practice	3:00 PM-4:20 PM	4:20 PM-4:30 PM	1/30	200.00	0.00	0.00	300.00
11/2/2021	Tue	LA	Russell Arena	Practice	3:00 PM-4:20 PM	4:20 PM-4:30 PM	1/30	200.00	0.00	0.00	300.00
11/3/2021	Wed	LA	Russell Arena	Practice	3:00 PM-4:20 PM	4:20 PM-4:30 PM	1/30	200.00	0.00	0.00	300.00
11/4/2021	Thu	LA	Russell Arena	Practice	3:00 PM-4:20 PM	4:20 PM-4:30 PM	1/30	200.00	0.00	0.00	300.00
11/5/2021	Fri	LA	Russell Arena	Practice	3:00 PM-4:20 PM	4:20 PM-4:30 PM	1/30	200.00	0.00	0.00	300.00
11/8/2021	Mon	LA	Russell Arena	Practice	3:00 PM-4:20 PM	4:20 PM-4:30 PM	1/30	200.00	0.00	0.00	300.00
11/9/2021	Tue	LA	Russell Arena	Practice	3:00 PM-4:20 PM	4:20 PM-4:30 PM	1/30	200.00	0.00	0.00	300.00
11/10/2021	Wed	LA	Russell Arena	Practice	1:00 PM-2:20 PM	2:20 PM-2:30 PM	1/30	150.00	0.00	0.00	225.00
11/11/2021	Thu	LA	Russell Arena	Practice	4:40 PM-6:30 PM	6:30 PM-6:40 PM	2/0	200.00	0.00	0.00	400.00
11/12/2021	Fri	LA	Russell Arena	Practice	1:00 PM-1:50 PM	1:50 PM-2:00 PM	1/0	150.00	0.00	0.00	150.00
11/15/2021	Mon	LA	Russell Arena	Practice	3:00 PM-4:20 PM	4:20 PM-4:30 PM	1/30	200.00	0.00	0.00	300.00
11/16/2021	Tue	LA	Russell Arena	Practice	3:00 PM-4:20 PM	4:20 PM-4:30 PM	1/30	200.00	0.00	0.00	300.00
11/17/2021	Wed	LA	Russell Arena	Practice	3:00 PM-4:20 PM	4:20 PM-4:30 PM	1/30	200.00	0.00	0.00	300.00
11/18/2021	Thu	LA	Russell Arena	Practice	3:00 PM-3:50 PM	3:50 PM-4:00 PM	1/0	200.00	0.00	0.00	200.00
11/22/2021	Mon	LA	Russell Arena	Practice	3:00 PM-4:20 PM	4:20 PM-4:30 PM	1/30	200.00	0.00	0.00	300.00
11/23/2021	Tue	LA	Russell Arena	Practice	3:00 PM-3:50 PM	3:50 PM-4:00 PM	1/0	200.00	0.00	0.00	200.00
11/27/2021	Sat	LA	Russell Arena	Practice	1:00 PM-1:50 PM	1:50 PM-2:00 PM	1/0	200.00	0.00	0.00	200.00
11/28/2021	Sun	LA	Russell Arena	Practice	1:00 PM-2:20 PM	2:20 PM-2:30 PM	1/30	200.00	0.00	0.00	300.00
11/29/2021	Mon	LA	Russell Arena	Practice	3:00 PM-4:20 PM	4:20 PM-4:30 PM	1/30	200.00	0.00	0.00	300.00
11/30/2021	Tue	LA	Russell Arena	Practice	5:30 PM-7:20 PM	7:20 PM-7:30 PM	2/0	200.00	0.00	0.00	400.00
12/1/2021	Wed	LA	Russell Arena	Practice	3:00 PM-3:50 PM	3:50 PM-4:00 PM	1/0	200.00	0.00	0.00	200.00
12/2/2021	Thu	LA	Russell Arena	Practice	3:00 PM-3:50 PM	3:50 PM-4:00 PM	1/0	200.00	0.00	0.00	200.00
12/6/2021	Mon	LA	Russell Arena	Practice	3:00 PM-4:20 PM	4:20 PM-4:30 PM	1/30	200.00	0.00	0.00	300.00
12/8/2021	Wed	LA	Russell Arena	Practice	3:00 PM-3:50 PM	3:50 PM-4:00 PM	1/0	200.00	0.00	0.00	200.00
12/9/2021	Thu	LA	Russell Arena	Practice	3:00 PM-3:50 PM	3:50 PM-4:00 PM	1/0	200.00	0.00	0.00	200.00
12/10/2021	Fri	LA	Russell Arena	Practice	5:30 PM-9:50 PM	9:50 PM-10:00 PM	4/30	200.00	0.00	0.00	900.00
12/11/2021	Sat	LA	Russell Arena	Practice	12:30 PM-4:50 PM	4:50 PM-5:00 PM	4/30	200.00	0.00	0.00	900.00
12/13/2021	Mon	LA	Russell Arena	Practice	3:00 PM-4:20 PM	4:20 PM-4:30 PM	1/30	200.00	0.00	0.00	300.00
12/14/2021	Tue	LA	Russell Arena	Practice	5:30 PM-7:50 PM	7:50 PM-8:00 PM	2/30	200.00	0.00	0.00	500.00
12/16/2021	Thu	LA	Russell Arena	Practice	3:00 PM-4:20 PM	4:20 PM-4:30 PM	1/30	200.00	0.00	0.00	300.00
12/17/2021	Fri	LA	Russell Arena	Practice	3:00 PM-4:20 PM	4:20 PM-4:30 PM	1/30	200.00	0.00	0.00	300.00
12/19/2021	Sun	LA	Russell Arena	Practice	1:00 PM-2:20 PM	2:20 PM-2:30 PM	1/30	200.00	0.00	0.00	300.00
12/20/2021	Mon	LA	Russell Arena	Practice	3:00 PM-3:50 PM	3:50 PM-4:00 PM	1/0	200.00	0.00	0.00	200.00
12/22/2021	Wed	LA	Russell Arena	Practice	3:00 PM-3:50 PM	3:50 PM-4:00 PM	1/0	200.00	0.00	0.00	200.00
12/23/2021	Thu	LA	Russell Arena	Practice	3:00 PM-3:50 PM	3:50 PM-4:00 PM	1/0	200.00	0.00	0.00	200.00
12/28/2021	Tue	LA	Russell Arena	Practice	9:00 AM-10:20 AM	10:20 AM-10:30 AM	1/30	150.00	0.00	0.00	225.00
12/29/2021	Wed	LA	Russell Arena	Practice	9:00 AM-10:20 AM	10:20 AM-10:30 AM	1/30	150.00	0.00	0.00	225.00
12/30/2021	Thu	LA	Russell Arena	Practice	9:00 AM-9:50 AM	9:50 AM-10:00 AM	1/0	150.00	0.00	0.00	150.00
12/31/2021	Fri	LA	Russell Arena	Practice	9:00 AM-10:20 AM	10:20 AM-10:30 AM	1/30	150.00	0.00	0.00	225.00
1/2/2022	Sun	LA	Russell Arena	Practice	3:00 PM-4:20 PM	4:20 PM-4:30 PM	1/30	200.00	0.00	0.00	300.00
1/3/2022	Mon	LA	Russell Arena	Practice	3:00 PM-4:20 PM	4:20 PM-4:30 PM	1/30	200.00	0.00	0.00	300.00
1/5/2022	Wed	LA	Russell Arena	Practice	3:00 PM-3:50 PM	3:50 PM-4:00 PM	1/0	200.00	0.00	0.00	200.00



# Lakeview Arena

300 W. Baraga Ave.  
Marquette, MI 49855

Phone: 906-228-0460

Fax: 906-228-0493

## Account Schedule Report

1/6/2022	Thu	LA	Russell Arena	Practice	3:00 PM-3:50 PM	3:50 PM-4:00 PM	1/0	200.00	0.00	0.00	200.00
1/7/2022	Fri	LA	Russell Arena	Practice	6:30 PM-8:50 PM	8:50 PM-9:00 PM	2/30	200.00	0.00	0.00	500.00
1/8/2022	Sat	LA	Russell Arena	Practice	12:30 PM-2:50 PM	2:50 PM-3:00 PM	2/30	200.00	0.00	0.00	500.00
1/10/2022	Mon	LA	Russell Arena	Practice	3:00 PM-4:20 PM	4:20 PM-4:30 PM	1/30	200.00	0.00	0.00	300.00
1/11/2022	Tue	LA	Russell Arena	Practice	3:00 PM-4:20 PM	4:20 PM-4:30 PM	1/30	200.00	0.00	0.00	300.00
1/12/2022	Wed	LA	Russell Arena	Practice	3:00 PM-4:20 PM	4:20 PM-4:30 PM	1/30	200.00	0.00	0.00	300.00
1/13/2022	Thu	LA	Russell Arena	Practice	3:00 PM-3:50 PM	3:50 PM-4:00 PM	1/0	200.00	0.00	0.00	200.00
1/17/2022	Mon	LA	Russell Arena	Practice	3:00 PM-4:20 PM	4:20 PM-4:30 PM	1/30	200.00	0.00	0.00	300.00
1/18/2022	Tue	LA	Russell Arena	Practice	3:00 PM-4:20 PM	4:20 PM-4:30 PM	1/30	200.00	0.00	0.00	300.00
1/19/2022	Wed	LA	Russell Arena	Practice	3:00 PM-3:50 PM	3:50 PM-4:00 PM	1/0	200.00	0.00	0.00	200.00
1/20/2022	Thu	LA	Russell Arena	Practice	5:30 PM-7:50 PM	7:50 PM-8:00 PM	2/30	200.00	0.00	0.00	500.00
1/21/2022	Fri	LA	Russell Arena	Practice	3:00 PM-3:50 PM	3:50 PM-4:00 PM	1/0	200.00	0.00	0.00	200.00
1/24/2022	Mon	LA	Russell Arena	Practice	3:00 PM-4:20 PM	4:20 PM-4:30 PM	1/30	200.00	0.00	0.00	300.00
1/25/2022	Tue	LA	Russell Arena	Practice	3:00 PM-4:20 PM	4:20 PM-4:30 PM	1/30	200.00	0.00	0.00	300.00
1/26/2022	Wed	LA	Russell Arena	Practice	12:00 PM-12:50 PM	12:50 PM-1:00 PM	1/0	150.00	0.00	0.00	150.00
1/31/2022	Mon	LA	Russell Arena	Practice	3:00 PM-3:50 PM	3:50 PM-4:00 PM	1/0	200.00	0.00	0.00	200.00
2/1/2022	Tue	LA	Russell Arena	Practice	3:00 PM-4:20 PM	4:20 PM-4:30 PM	1/30	200.00	0.00	0.00	300.00
2/2/2022	Wed	LA	Russell Arena	Practice	3:00 PM-4:20 PM	4:20 PM-4:30 PM	1/30	200.00	0.00	0.00	300.00
2/3/2022	Thu	LA	Russell Arena	Practice	3:00 PM-3:50 PM	3:50 PM-4:00 PM	1/0	200.00	0.00	0.00	200.00
2/7/2022	Mon	LA	Russell Arena	Practice	3:00 PM-4:20 PM	4:20 PM-4:30 PM	1/30	200.00	0.00	0.00	300.00
2/8/2022	Tue	LA	Russell Arena	Practice	5:30 PM-7:50 PM	7:50 PM-8:00 PM	2/30	200.00	0.00	0.00	500.00
2/9/2022	Wed	LA	Russell Arena	Practice	3:00 PM-3:50 PM	3:50 PM-4:00 PM	1/0	200.00	0.00	0.00	200.00
2/10/2022	Thu	LA	Russell Arena	Practice	3:00 PM-4:20 PM	4:20 PM-4:30 PM	1/30	200.00	0.00	0.00	300.00
2/11/2022	Fri	LA	Russell Arena	Practice	3:00 PM-3:50 PM	3:50 PM-4:00 PM	1/0	200.00	0.00	0.00	200.00
2/13/2022	Sun	LA	Russell Arena	Practice	1:00 PM-2:20 PM	2:20 PM-2:30 PM	1/30	200.00	0.00	0.00	300.00
2/14/2022	Mon	LA	Russell Arena	Practice	3:00 PM-3:50 PM	3:50 PM-4:00 PM	1/0	200.00	0.00	0.00	200.00
2/16/2022	Wed	LA	Russell Arena	Practice	3:00 PM-3:50 PM	3:50 PM-4:00 PM	1/0	200.00	0.00	0.00	200.00
2/17/2022	Thu	LA	Russell Arena	Practice	5:30 PM-7:50 PM	7:50 PM-8:00 PM	2/30	200.00	0.00	0.00	500.00
2/18/2022	Fri	LA	Russell Arena	Practice	3:00 PM-3:50 PM	3:50 PM-4:00 PM	1/0	200.00	0.00	0.00	200.00
2/21/2022	Mon	LA	Russell Arena	Practice	3:00 PM-4:20 PM	4:20 PM-4:30 PM	1/30	200.00	0.00	0.00	300.00
2/22/2022	Tue	LA	Russell Arena	Practice	3:00 PM-3:50 PM	3:50 PM-4:00 PM	1/0	200.00	0.00	0.00	200.00
2/23/2022	Wed	LA	Russell Arena	Practice	3:00 PM-3:50 PM	3:50 PM-4:00 PM	1/0	200.00	0.00	0.00	200.00
2/24/2022	Thu	LA	Russell Arena	Practice	5:30 PM-7:50 PM	7:50 PM-8:00 PM	2/30	200.00	0.00	0.00	500.00
2/25/2022	Fri	LA	Russell Arena	Practice	3:00 PM-3:50 PM	3:50 PM-4:00 PM	1/0	200.00	0.00	0.00	200.00
2/26/2022	Sat	LA	Russell Arena	Practice	1:00 PM-3:50 PM	3:50 PM-4:00 PM	3/0	200.00	0.00	0.00	600.00
2/28/2022	Mon	LA	Russell Arena	Practice	3:00 PM-3:50 PM	3:50 PM-4:00 PM	1/0	200.00	0.00	0.00	200.00

118 (hrs) / 0 (min)

<b>Sub Total</b>	<b>\$23,150.00</b>
<b>Tax</b>	<b>\$0.00</b>
<b>Grand Total</b>	<b>\$23,150.00</b>



# LAKEVIEW ARENA

## EXHIBIT A

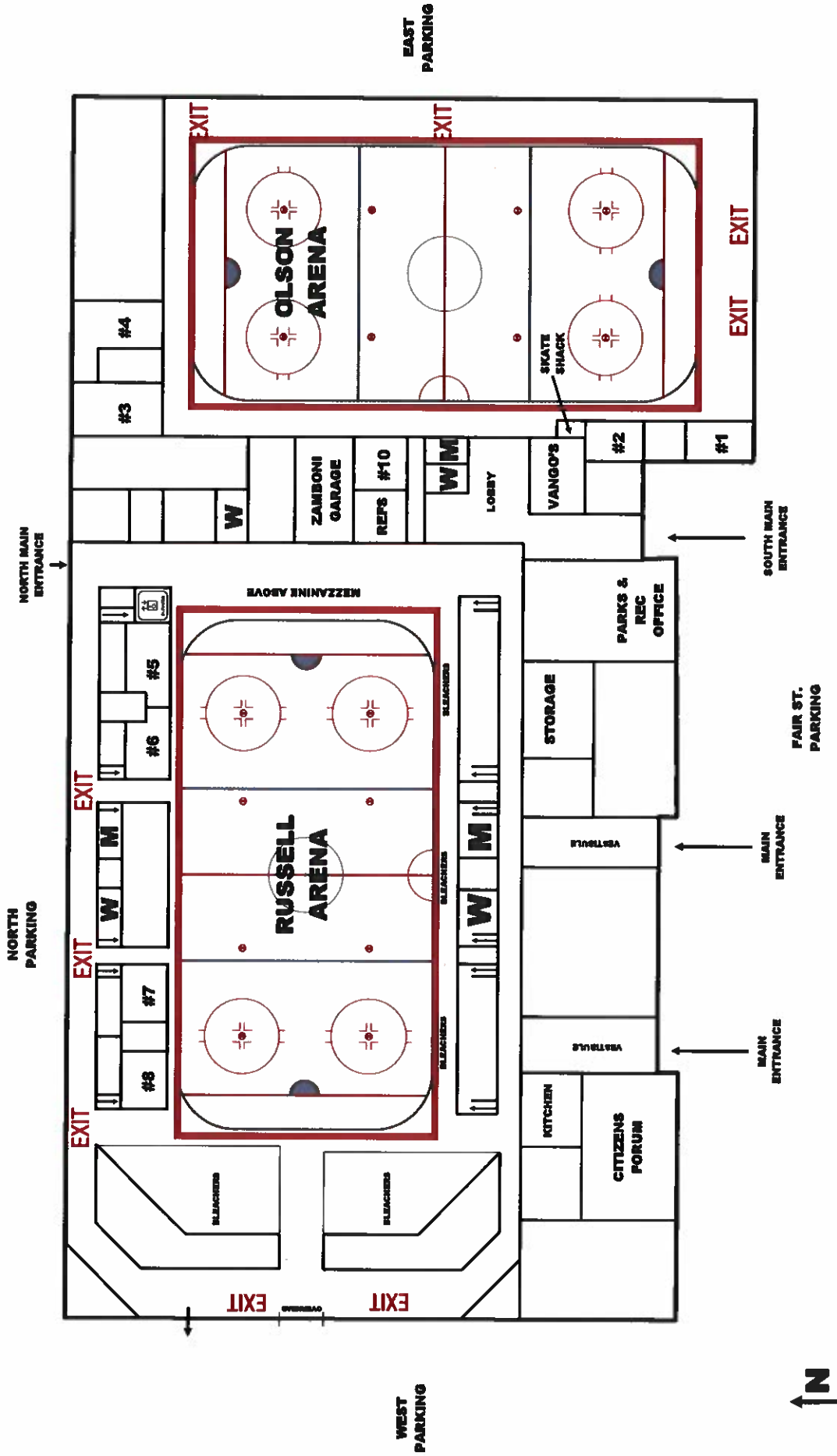

## CERTIFICATE OF INSURANCE

<b>Producer</b> <b>SET SEG</b> 1520 Earl Ave East Lansing, MI 48823	THIS CERTIFICATE IS ISSUED AS A MATTER OF INFORMATION ONLY AND CONFERS NO RIGHTS UPON THE CERTIFICATE HOLDER. THIS CERTIFICATE DOES NOT AMEND, EXTEND OR ALTER THE COVERAGE AFFORDED BY THE POLICIES BELOW.
--	---

<b>Insured</b> <b>Marquette Area Public Schools</b> 1201 W Fair Avenue Marquette, MI 49855-2688	<p style="text-align: center;"><b>COMPANIES AFFORDING COVERAGE</b></p> <p><b>A</b> MASB-SEG Property/Casualty Pool, Inc.</p> <p><b>B</b> Workers Compensation &amp; Employers Liability</p>
--	---

THIS IS TO CERTIFY THAT THE POLICIES OF INSURANCE LISTED BELOW HAVE BEEN ISSUED TO THE INSURED NAMED ABOVE FOR THE POLICY PERIOD INDICATED, NOTWITHSTANDING ANY REQUIREMENT, TERM OR CONDITION OF ANY CONTRACT OR OTHER DOCUMENT WITH RESPECT TO WHICH THIS CERTIFICATE MAY BE ISSUED OR MAY PERTAIN, THE INSURANCE AFFORDED BY THE POLICIES DESCRIBED HEREIN IS SUBJECT TO ALL TERMS, EXCLUSIONS AND CONDITIONS OF SUCH POLICIES.

CO LTR	TYPE OF INSURANCE	POLICY NUMBER	EFFECTIVE DATE	EXPIRATION DATE	LIMITS	
<b>A</b>	<b>GENERAL LIABILITY</b> <input checked="" type="checkbox"/> Comprehensive Form <input checked="" type="checkbox"/> Premises/Operations <input checked="" type="checkbox"/> Incidental Medical Malpractice Coverage <input checked="" type="checkbox"/> Products/Completed Operations <input checked="" type="checkbox"/> Contractual <input checked="" type="checkbox"/> Independent Contractors <input checked="" type="checkbox"/> Broad Form Property Damage <input checked="" type="checkbox"/> Personal Injury	PC-0000401	7/1/21	7/1/22	BI & PD COMBINED OCCURRENCE  BI & PD COMBINED AGGREGATE  PERSONAL INJURY OCCURRENCE  PERSONAL INJURY AGGREGATE	\$1,000,000  N/A  \$1,000,000  N/A
<b>A</b>	<b>AUTOMOBILE LIABILITY</b> <input checked="" type="checkbox"/> Any Auto <input checked="" type="checkbox"/> All Owned Autos (Priv. Pass. & Other) <input checked="" type="checkbox"/> Hired Autos <input checked="" type="checkbox"/> Non-Owned Autos	PC-0000401	7/1/21	7/1/22	BODILY INJURY & PROPERTY DAMAGE COMBINED	\$1,000,000
<b>B</b>	<b>WORKERS' COMPENSATION &amp; EMPLOYERS' LIABILITY</b>	EWC009496	7/1/21	7/1/22	<b>WORKERS' COMPENSATION</b>  <b>EMPLOYERS' LIABILITY</b>	STATUTORY  \$750,000

**DESCRIPTION** City of Marquette is added as an additional insured for liability, solely as its interest may appear on behalf of the insured school districts' use of facilities for MSHS Ice Contract in the coverage year.

<b>CERTIFICATE HOLDER</b> City of Marquette Community Services 401 East Fair Avenue Marquette, MI 49855	SHOULD ANY OF THE ABOVE DESCRIBED POLICIES BE CANCELLED BEFORE THE EXPIRATION DATE THEREOF, THE ISSUING COMPANY WILL ENDEAVOR TO MAIL 10 DAYS WRITTEN NOTICE TO THE CERTIFICATE HOLDER NAMED TO THE LEFT, BUT FAILURE TO MAIL SUCH NOTICE SHALL IMPOSE NO OBLIGATION OR LIABILITY OF ANY KIND UPON THE COMPANY, ITS AGENTS OR REPRESENTATIVES.
---	--

**AUTHORIZED REPRESENTATIVE**

*Emorie Bond*

Emorie Bond  
 PROPERTY/CASUALTY DEPARTMENT

Date January 11, 2022